

Reservdelar - K.T.S Huggarvagn 10,0 - 11,0 ton

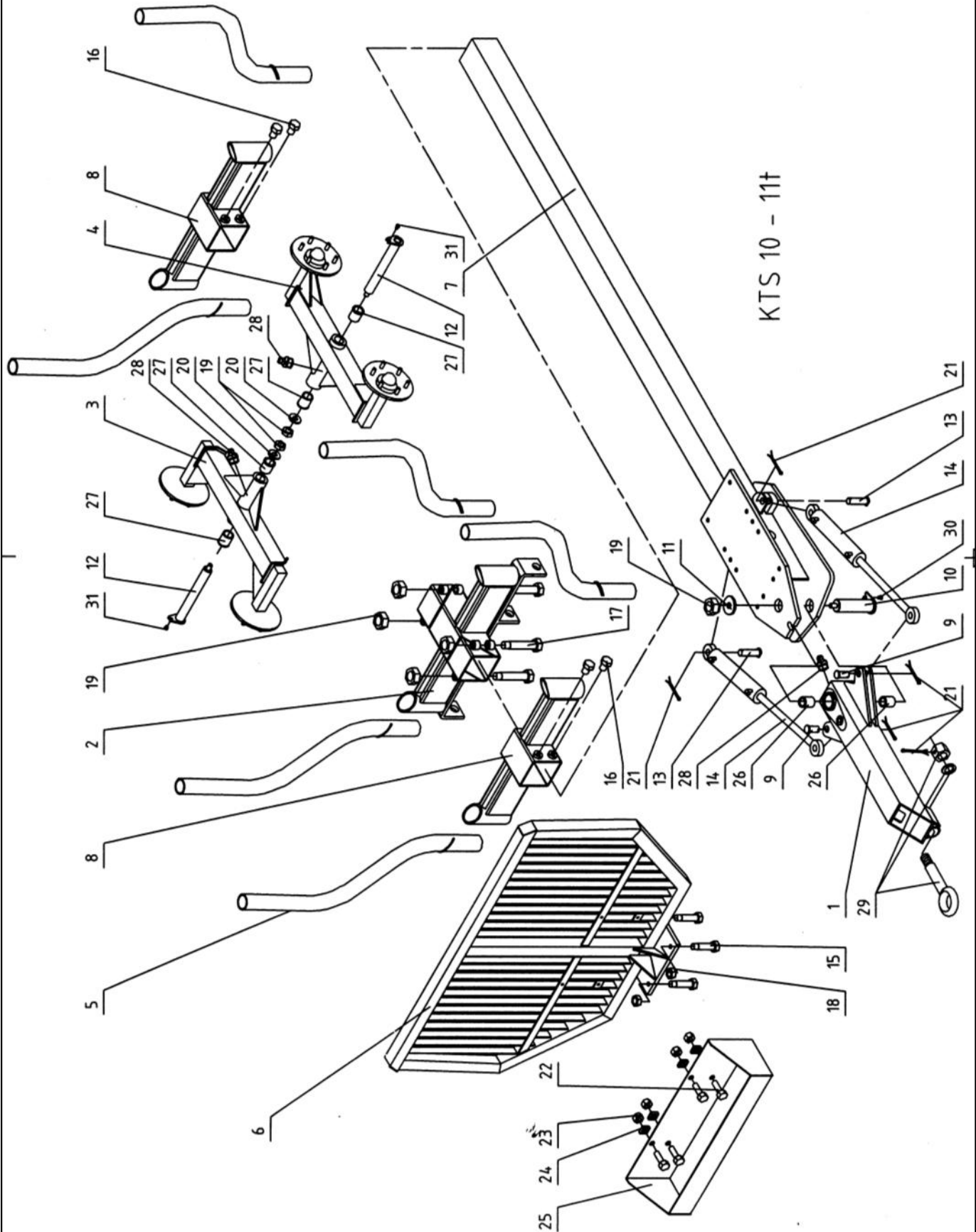

**Reservdelar - K.T.S Huggarvagn 10,0 - 11,0 ton**  
**11/06/2007**

<b>Pos. Item</b>	<b>Reservdel nr Spare Part No.</b>	<b>Antal Qty.</b>	<b>Beskrivning Description</b>	<b>Anmärkning Notes</b>
1	TT 01.1 00 00	1	Dragögla	
2 2b	TT 02 1 00 00 TT 02 6 00 00	1	Bogie bolster	1.- -Nr. 50094 Nr. 50095 - -
3 3b	TT03.1 00 00	1	Bogie left side	1.- -009 2. 010 -- (shorter bushing)
4 4b	TT03.2 00 00	1	Bogie right side	1.- -009 2. 010 -- (shorter bushing)
5 5b	TT04.1 00 00 TT04.4 00 00	6	Stötta	1.- - 05/2005 2. 05/2005---
6	TT05.2 00 00	1	Grind	1.KTS 1064 - - (narow on 90mm)
7 7b	TT08.1 00 00 TT08.3 00 00	1	Centralram	1.---05/2005 2.05/2005---
8	TT09.2 00 00	2	Bolster	1.KTS 1064 - - (narow on 90mm)
9	TT01 00 01	1	Pin	
10	TT01 00 03	1	Pin	1: From 09/2005 - - (pin fixed by bolt)
11	TT01 00 04	1	Bricka	
12	TT02 00 01	2	Axle	1. From 09/2005 - - (pin fixed by bolt)
13	TT08 00 01	2	Pin	1. From 01/03/2005 (L=120)
14	HC80/40-290 TT	2	Hydraulcylinder	
15	DIN 931-1 - M20 x 80 10.9	4	Bult	
16	DIN 933 - M24 x 30	4	Hex-Head Bolt	
17	DIN 931-1 - M24 x 160	4	Hex-Head Bolt	
18	DIN 985 - M20	4	Mutter	
19	DIN 985 - M24	7	Mutter	
20	DIN 9021 - 26	2	Bricka	
21	DIN 94 - 5 x 40	5	Saxpinne	
22	M10x35	4	Bult	
23	DIN 985 - M10	4	Mutter	
24	TT 10 00 01	4	Plate	
25	TT 10 1 00 00	1	Motorsågslåda	
	TT 04 2 00 00	6	Stake extention	
26 26b	75/70/40 75/70/85-70	2	Bussning	1. - -Nr.70034 2. Nr.70035 - -
27	50/55/65-40	5	Bronsbusning	1. Nr. 010 - -
28	DIN7141 10x1	3	Smörjnippel	
29	BPT 35001	1	Hook	
30	DIN 6921 M16x35	1	Hex-Head Bolt	
31	DIN 6921 M12x20	2	Hex-Head Bolt	